

# 16 rue Manin

75019 Paris  
floor 5 out of 7  
bedrooms 2  
443.58 sqft  
41.21 sqm  
available from now on

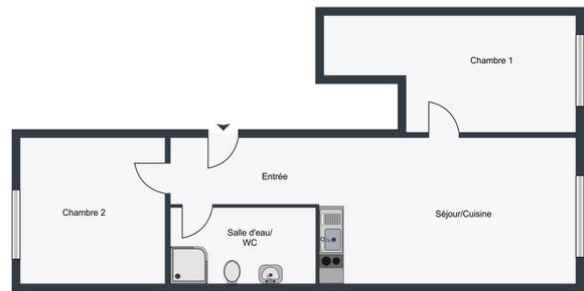

+33 7 85 99 37 74

## rent

base rent	EUR 1 084
additional rent	EUR 537
operational costs	EUR 90
total rent	EUR 1 711
deposit	EUR 1 621
rent increase	26,3 EUR / sqm
reference	

## apartment

flooring	parquet
built-in kitchen	
dishwasher	
washing machine	

## building

construction year	1908
-------------------	------

## energy

energy efficiency rating D	
date of certificate	28/06/2024
current energy consumption	234 kWh/m <sup>2</sup> *a
gas efficiency rating B	
current gas consumption	9 kgeqCO <sub>2</sub> /m <sup>2</sup>



min annual energy consumption cost EUR 960  
max annual energy consumption cost EUR 1 340  
energy reference date 01/01/2021

**distance, meters**

closest subway station Ourcq



