

# 119 avenue d'Ivry

75013 Paris  
floor 1 out of 7  
189.88 sqft  
17.64 sqm  
available from now on

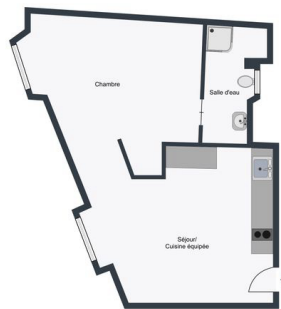

+33 7 85 99 37 74

## rent

base rent	EUR 601
additional rent	EUR 315
operational costs	EUR 70
total rent	EUR 986
deposit	EUR 916
rent increase	34,1 EUR / sqm
reference	

## apartment

flooring	parquet
store room	
built-in kitchen	
dishwasher	
washing machine	

## building

construction year	1900
-------------------	------

## energy

energy efficiency rating E	
date of certificate	17/03/2026
current energy consumption	318 kWh/m <sup>2</sup> *a
gas efficiency rating B	
current gas consumption	12 kgeqCO <sub>2</sub> /m <sup>2</sup>



min annual energy  
consumption cost EUR 610  
max annual energy  
consumption cost EUR 840  
energy  
consumption 01/01/2021  
reference date

**distance, meters**

closest subway  
station Tolbiac



